

Enhancing the virtuous cycle of parent-child interaction and social stability in families

Online childcare parents self-management

Name :Zheyang Tao supervisor Supervisor: Yuan Yin

Abstract

Purpose: The main purpose of this study is to investigate how parents play a central role in the care of children aged 3-6. This study aims to reveal the level of parental involvement, the challenges they face, and the strategies they adopt to ensure effective childcare.

Method: Collect comprehensive insights using a mixed approach. Qualitative data is obtained through semi-structured interviews with parents, eliciting their experiences, perspectives, and strategies. Quantitative data is collected through surveys.

Introduction & Background

This study explores parenting practices for children aged 3 to 6, with a particular focus on parents' perspectives and participation. As this stage of development is crucial for cognitive, social, and emotional growth, understanding the role of parents in shaping childcare becomes crucial. The abstract outlines the main objectives, methods, key findings, and significance of the study.

Diagram / Design

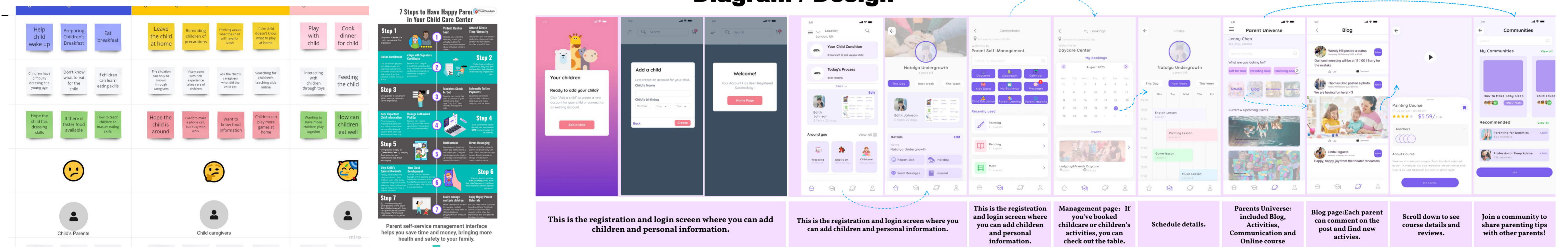

Study Methodolog

Literature Review: online products and offline products

Survey: interview and questionnaire

Prototype 1: App design

User testing

Prototype 2

Testing & Evaluation

Participants: The test object for the parents of 3-6 years old children

Feedback: The colors could be changed, the functionality is a bit more concise, and you can add a child watch function

Update : App product features built on the measures already in place in the past, to update and optimize to add more powerful features.

Research Results

After digging deeper into the users' needs through interviews, it became clear that their needs and dilemmas were the same, but the issues that led to the child's problems might be different.

The data from the questionnaire proved that most parents of Chinese children work similar hours, 6-8 hours a day, and that they are not able to find out what is happening to their children while they are at work and need to contact their caregivers by phone.

Conclusions & Future Work

Our research findings emphasize the importance of parental involvement in educational activities and emotional support, as well as the challenges they face in balancing work commitments and screen time management. The research findings emphasize the need for tailored support and resources to enhance parental engagement, such as offline professional childcare centers providing services.

In addition, this study reiterates the importance of recognizing that parents today cannot balance family life and work as the core figures in childcare decision-making.